



AIA Document G701™ – 2017

Change Order

PROJECT: (Name and address)
Clay H.S. Erosion Control/Stormwater
2025 FL 16
Green Cove Springs, FL 32043
Project #C-12-19/20

CONTRACT INFORMATION:
Contract For: General Construction
Date: April 2, 2020

CHANGE ORDER INFORMATION:
Change Order Number: 1
Date: June 25, 2020

OWNER: (Name and address)
School Board of Clay County
900 Walnut St.
Green Cove Spring, FL 32043

ARCHITECT: (Name and address)
Michele M. Agee, P.E., P.A.
1329 Kingsley Ave, Suite C
Orange Park, FL 32073

CONTRACTOR: (Name and address)
Hager Construction Company
1404 Kings St.
Jacksonville, FL 32209

THE CONTRACT IS CHANGED AS FOLLOWS:

(Insert a detailed description of the change and, if applicable, attach or reference specific exhibits. Also include agreed upon adjustments attributable to executed Construction Change Directives.)

Install 24" pipe liner, raise lid of existing manhole, and construct 20' of new sidewalk (lump sum) \$68,942.40

The original Contract Sum was	\$	165,969.00
The net change by previously authorized Change Orders	\$	0.00
The Contract Sum prior to this Change Order was	\$	165,969.00
The Contract Sum will be increased by this Change Order in the amount of	\$	68,942.40
The new Contract Sum including this Change Order will be	\$	234,911.40

The Contract Time will be increased by Thirty (30) days.
The new date of Substantial Completion will be August 30, 2020

NOTE: This Change Order does not include adjustments to the Contract Sum or Guaranteed Maximum Price, or the Contract Time, that have been authorized by Construction Change Directive until the cost and time have been agreed upon by both the Owner and Contractor, in which case a Change Order is executed to supersede the Construction Change Directive.

NOT VALID UNTIL SIGNED BY THE ARCHITECT, CONTRACTOR AND OWNER.

Michele M. Agee, P.E. P.A.
ARCHITECT (Firm name)
Michele M. Agee
SIGNATURE
Michele M. Agee
PRINTED NAME AND TITLE
June 8, 2020
DATE

Hager Construction Company
CONTRACTOR (Firm name)
John Hager
SIGNATURE
John Hager
PRINTED NAME AND TITLE
June 8, 2020
DATE

School Board of Clay County
OWNER (Firm name)

SIGNATURE
Carol Studdard, Board Chair
PRINTED NAME AND TITLE
June 25, 2020
DATE

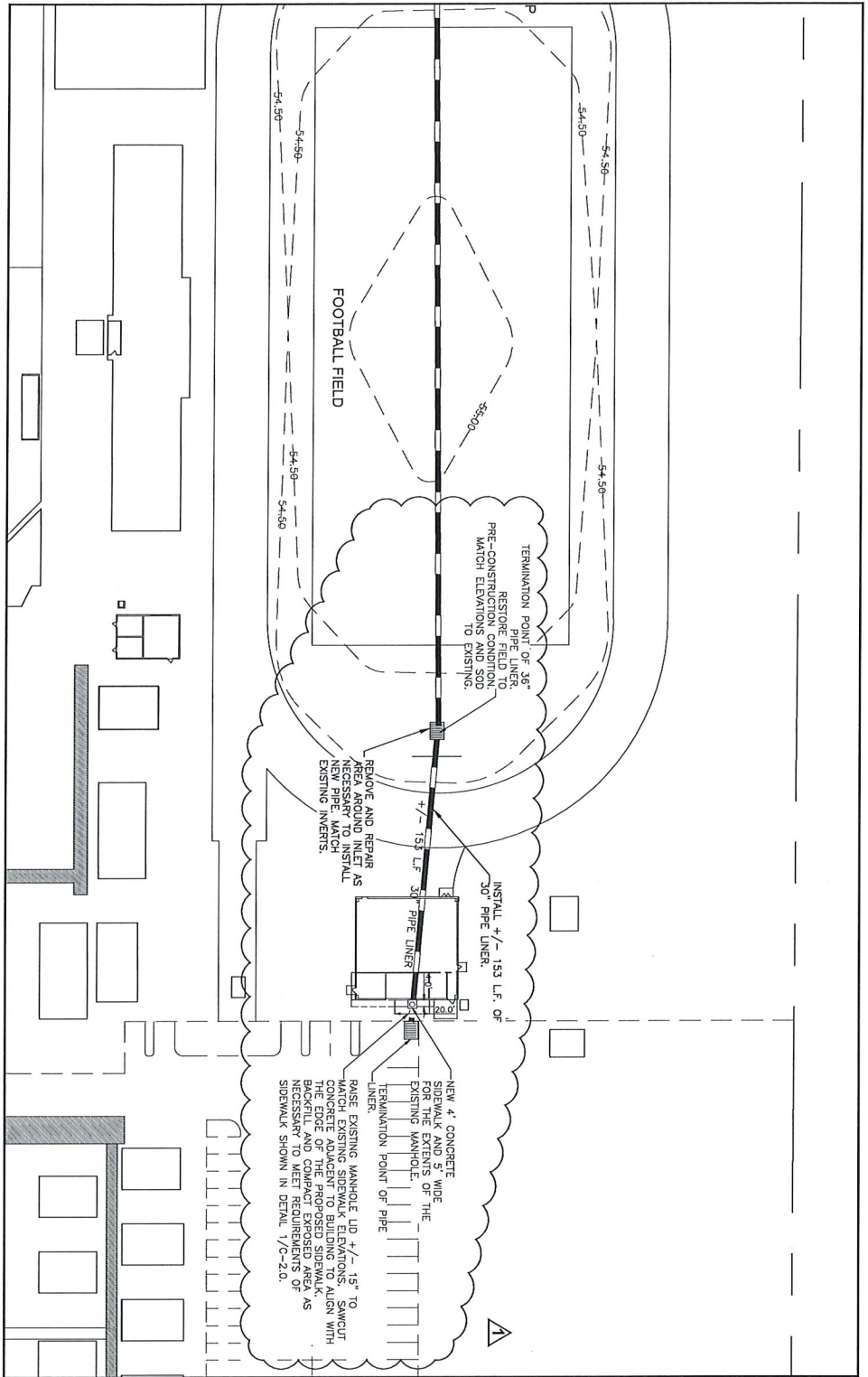

- GENERAL NOTES**
1. CONTRACTOR WILL PROVIDE ENGINEER WITH SHOP DRAWINGS OF OMEGA LINER PRIOR TO CONSTRUCTION.
 2. PROVIDE METHOD OF JOINT REPAIR TO ENGINEER PRIOR TO COMMENCING CONSTRUCTION.

DRAINAGE NOTES

1. CONTRACTOR TO ENSURE THAT THE LATEST APPROVED SETS OF PROJECT MANUAL SPECIFICATIONS ARE BEING UTILIZED FOR CONSTRUCTION OF ALL STRUCTURES.
2. CONTRACTORS TO SUBMIT SHOP DRAWINGS TO ENGINEER FOR ALL STRUCTURES PRIOR TO ORDERING.
3. THE CONTRACTOR SHALL BE RESPONSIBLE FOR THE LOCATION OF EXISTING UTILITIES AND SHALL EXPOSE EXPOSED UTILITIES PRIOR TO CONSTRUCTION. CONTRACTOR SHALL REPAIR OR PAY FOR ALL DAMAGES MADE TO EXISTING STRUCTURES AND UTILITIES.
4. THE CONTRACTOR MUST OBTAIN ALL PERMITS PRIOR TO BE KEPT ON CONSTRUCTION SITE AT ALL TIMES AS REQUIRED.
5. UNSUITABLE MATERIAL ENCOUNTERED SHALL BE LEGALLY DISPOSED OR STORED AT THE CONTRACTOR'S EXPENSE OR DEPOSITED IN A STORAGE AREA AS DETERMINED BY THE ENGINEER. CONTRACTOR SHALL PROVIDE ADEQUATE INFORMATION CONCERNING UNSUITABLE MATERIAL, CONDITIONS AND ELEVATIONS PRIOR TO CONSTRUCTION.
6. CONTRACTOR SHALL VERIFY EXISTING PAVEMENT AND BUILDING FOUNDATIONS AT ALL DOWNSTREAM DISCHARGE POINTS WITHIN THE PROJECT LIMITS PRIOR TO CONSTRUCTION.
7. CONTRACTOR MUST PROVIDE CERTIFIED TEST RESULTS OF THE EXISTING PAVEMENT AND BUILDING FOUNDATIONS TO THE ENGINEER FROM AN INDEPENDENT QUALIFIED TEST LABORATORY.
8. DURING CONSTRUCTION CONTRACTOR TO PLACE HAY MATS AND SILT CURTAINS AT ALL DOWNSTREAM DISCHARGE POINTS WITHIN THE PROJECT LIMITS TO PREVENT EROSION AND TO PROTECT THE EXISTING PAVEMENT AND BUILDING FOUNDATIONS FROM THE CONSTRUCTION SITE AND SLOTTED SAND BAGS SHALL BE USED TO PROTECT EXISTING PAVEMENT AND BUILDING FOUNDATIONS FROM THE CONSTRUCTION SITE AND SLOTTED SAND BAGS SHALL BE USED TO PROTECT EXISTING PAVEMENT AND BUILDING FOUNDATIONS FROM THE CONSTRUCTION SITE.
9. CONTRACTOR TO MAINTAIN PROPER UNDERPASSAGE UNDER ALL EXISTING STRUCTURES AND TO MAINTAIN PROPER UNDERPASSAGE UNDER ALL EXISTING STRUCTURES AND TO MAINTAIN PROPER UNDERPASSAGE UNDER ALL EXISTING STRUCTURES.
10. ALL CONSTRUCTION TO BE IN ACCORDANCE WITH LATEST CLAY COUNTY PUBLIC SCHOOLS CODES.
11. PRIOR TO DISCHARGE OF PRODUCE WATERS AND SURFACE WATERS OF THE STATE AS DENIED IN CHAPTER 62-600 OF THE FLORIDA STATUTES, CONTRACTOR SHALL OBTAIN A PERMIT FROM THE FLORIDA DEPARTMENT OF ENVIRONMENTAL PROTECTION FOR THE DISCHARGE OF PRODUCE WATERS TO ANY WATERWAY.
12. CONTRACTOR SHALL BE RESPONSIBLE FOR VERIFYING EXISTING CONDITIONS AND FOR OBTAINING ALL NECESSARY PERMITS AND A SEPARATE OF WORK. CONTRACTOR SHALL MAINTAIN PROGRESS AND RECORDS OF ALL WORK. CONTRACTOR SHALL MAINTAIN PROGRESS AND RECORDS OF ALL WORK. CONTRACTOR SHALL MAINTAIN PROGRESS AND RECORDS OF ALL WORK.
13. ALL DISTURBED GRASS AREAS WILL BE RESTORED TO ORIGINAL CONDITION AND ALL DISTURBED GRASS AREAS WILL BE RESTORED TO ORIGINAL CONDITION AND ALL DISTURBED GRASS AREAS WILL BE RESTORED TO ORIGINAL CONDITION.
14. ALL PILE WORK TO BE ACCOMPLISHED PER FOOT STANDARDS.

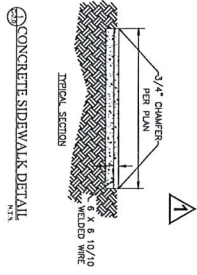

	CLAY HIGH SCHOOL EROSION CONTROL/STORMWATER SYSTEM REPAIR 2025 STATE ROAD 16, GREEN COVE SPRINGS, FL 32043 CLAY COUNTY FLORIDA	MICHELE M. AGEE, P.E., P.A. 1329 KINGSMLEY AVE., SUITE C GUNN HILL, FLORIDA 32037 904-264-9911 (PH) CCM 26142
	PROJECT NO. 2025-001 SHEET NO. 1 OF 1 DATE: 11/15/2024 DRAWN BY: M. AGEE CHECKED BY: M. AGEE APPROVED BY: M. AGEE	DRAINAGE PLAN SCALE: AS SHOWN DATE: 11/15/2024

27 May 2020 (Revised)

ASI #001-R1, to Drawings and Specifications dated **February 6, 2020 for Clay High School**, as prepared by Michele M. Agee, P.E., P.A., 1329 Kinsley Ave., Suite C, Orange Park, FL

This **ASI #001-R1** shall hereby be and become a part of the Contract Documents the same as if originally bound thereto.

The following clarifications, amendments, additions, revisions, changes and modifications change the original Contract Documents only in the amount and to the extent hereinafter specified and set forth in this **ASI #001-R1**.

PURPOSE OF THIS ASI, SUMMARY:

The purpose of this ASI is to: Provide approximately 154 l.f. of 30" pipe liner as shown on revised plan sheet C-2.0, raise the storm manhole lid on the west side of the field house, and replace 20' of sidewalk on the west side of the field house.

CHANGES TO SPECIFICATIONS

Civil:

ITEM NO. 1.: None in this document

CHANGES TO CONTRUCTION PLANS

Civil:

ITEM NO. 1.: C-2.0 Drainage Plan

- A. Additional pipe liner, approximately 154 l.f.
- B. Raise lid of existing storm manhole +/- 15" to existing sidewalk elevation.
- C. Remove +/- 10' of existing sidewalk, and construct 20' of new 4' wide sidewalk. Construct 5' wide sidewalk from edge of manhole to edge of manhole. Manhole lid will extend through sidewalk to match sidewalk elevations.

