

**ATTENDANCE BOUNDARY DEVELOPMENT
FOR
PLANTATION OAKS ELEMENTARY SCHOOL**

**WITH
REVISIONS TO CONTIGUOUS ATTENDANCE
BOUNDARIES OF
ARGYLE ELEMENTARY AND
OAKLEAF VILLAGE ELEMENTARY**

**AND
ADMINISTRATIVE REVISIONS TO
TYNES ELEMENTARY AND
OAKLEAF JUNIOR HIGH**



December 18, 2008

**Superintendent of Schools
Ben Wortham**

**TABLE OF CONTENTS
FOR
PLANTATION OAKS ELEMENTARY SCHOOL
AND
EXISTING AFFECTED SCHOOLS**

	<u>PAGE #</u>
I. REDISTRICTING PROCESS	1
II. TIMELINE FOR REDISTRICTING	2
III. CONSIDERATIONS / CRITERIA FOR REDISTRICTING	3
IV. SCHOOL PROJECTIONS	4
V. PROPOSED ATTENDANCE BOUNDARY MAP FOR POE, AES AND OVE	5
VI. EXISTING ATTENDANCE BOUNDARY MAPS FOR AES, OVE AND OLS	6-10
VII. PROPOSED ATTENDANCE BOUNDARY MAPS FOR TES AND OLJH	11-12
VIII. EXISTING ATTENDANCE BOUNDARY MAP FOR TES	13
IX. RECOMMENDED ATTENDANCE BOUNDARY DESCRIPTIONS	14-19
X. ADVERTISEMENTS	20

REDISTRICTING PROCESS

- STEP 1:** The Division of Support Services' staff analyzes existing attendance boundaries. This analysis is to include, but not necessarily limited to, the following criteria: Historic enrollment trends, projected enrollment trends, school size and capacity, specific area population demographics, proximity, neighborhood concept, school bus transportation, walking distance, safety, stability and equity of distribution.
- STEP 2:** From data developed by the Division of Support Services' staff in the Step 1 analysis, at least three (3) options are to be developed. These options are to be unranked and are to represent the best alternatives in meeting the criteria of Step 1.
- STEP 3:** A meeting is scheduled to include the Assistant Superintendent of Support Services, Director of Facility Planning and Construction, the Coordinator of Planning, the Director of Transportation, the appropriate Director of Elementary or Secondary Education, the Director of Exceptional Education (as necessary) and each affected School Principal. The purpose of the meeting is to rank the three (3) alternatives.
- STEP 4:** The Assistant Superintendent of Support Services will agenda the ranked redistricting alternatives during a Superintendent's staff meeting for general staff questions and discussion. The purpose is to encourage staff input to the Superintendent in order for the Superintendent to formulate his/her recommendation. Once the Superintendent's recommendation is formulated, the recommendation will be posted in each affected school. The Coordinator of Facility Planning will correspond with each affected school's School Advisory Committee for input, identification of timelines and process.
- STEP 5:** The Superintendent presents his/her recommendation to the School Board at a advertised School Board meeting. The Superintendent will request authorization to advertise the recommended school attendance boundaries in a local newspaper of general circulation. The advertisement will be for three (3) consecutive weeks. The recommendation will continue to be posted in each affected school and placed in the school newsletter if at all possible. The public will be allowed to address the recommendation if requested.
- STEP 6:** The Superintendent, after having advertised his/her recommendation, and after due consideration of additional input from staff and/or citizens, will agenda at the next School Board meeting approval of the original recommendation or revised recommendation for school attendance boundaries. A Public Hearing will be conducted by the School Board to seek public input at the meeting. Upon concluding the Public Hearing, the Superintendent's recommendation will be opened for discussion by the Board and ultimately acted upon either as the Superintendent's original or revised recommendation, as revised by the Board or tabled to a time certain for additional time of consideration.
- STEP 7:** Upon the School Board acting upon a new or revised school attendance boundary, the District's Planning Department will update and post new or revised attendance boundary descriptions and maps, communicate same to each affected school, communicate same to the Board of Realtors and to any large development within the attendance boundary being affected.

Timeline

ATTENDANCE BOUNDARY DEVELOPMENT for PLANTATION OAKS ELEMENTARY and Revisions to Existing Impacted Schools

Date	Action Item
September 2008	Background data developed
September 2008	Options developed
October 2008	Staff & Principals review options
December 2008	Present to School Board & authorization to advertise
January 2009	School Board Public Hearing to approve
February 2009	Attendance Boundary map updates

CONSIDERATIONS/CRITERIA FOR REDISTRICTING

- SAFETY
- ANALYSIS OF EXISTING ATTENDANCE BOUNDARIES
- SCHOOL CAPACITY AND LEVEL OF SERVICE
- GEOGRAPHIC AREA CHARACTERISTICS (MATURE VS. GROWING)
- PROJECTED ENROLLMENT TRENDS
- SCHOOL BOARD FACILITY LIST
- SHORT RANGE AND LONG RANGE ENROLLMENT FORECASTS
- NEIGHBORHOOD CONCEPT
- PROXIMITY FOR STUDENT ATTENDANCE (IF NOT NEIGHBORHOOD, THEN AS CLOSE AS POSSIBLE)
- MINIMUM SIZE OF SCHOOL
- BALANCED STUDENT DISTRIBUTION
- TRANSPORTATION
 - WALKING DISTANCE/PATHS
 - PARENT/STUDENT PERSONAL TRANSPORTATION
 - SCHOOL BUS TRANSPORTATION

SCHOOL PROJECTIONS**

PLANTATION OAKS ELEMENTARY				2%	Growth*
Grade	<u>10-Sep</u>	<u>11-Oct</u>	<u>12-Nov</u>	<u>13-Dec</u>	<u>13-14</u>
PK	5	5	5	5	5
K	75	77	78	80	81
1	75	77	78	80	81
2	84	86	87	89	91
3	105	107	109	111	114
4	100	102	104	106	108
5	<u>88</u>	<u>90</u>	<u>92</u>	<u>93</u>	<u>95</u>
Total:	532	543	553	564	575

ARGYLE ELEMENTARY				0.50%	Growth*
Grade	<u>10-Sep</u>	<u>11-Oct</u>	<u>12-Nov</u>	<u>13-Dec</u>	<u>13-14</u>
PK	14	14	14	14	14
K	100	101	101	102	102
1	106	107	107	108	108
2	115	116	116	117	117
3	105	106	106	107	107
4	131	132	132	133	134
5	<u>140</u>	<u>141</u>	<u>141</u>	<u>142</u>	<u>143</u>
Total:	711	714	718	722	725

OAKLEAF JUNIOR HIGH				2%	Growth*
Grade	<u>10-Sep</u>	<u>11-Oct</u>	<u>12-Nov</u>	<u>13-Dec</u>	<u>13-14</u>
6	396	404	412	420	429
7	360	367	375	382	390
8	<u>427</u>	<u>436</u>	<u>444</u>	<u>453</u>	<u>462</u>
Total:	1183	1207	1231	1255	1281

Notes: *Based on 9/29/08 local student population data in proposed school zone.

****Student projections based on student address. Projections do not account for approved variances that have students leaving or entering the school attendance zone in which the student resides.**

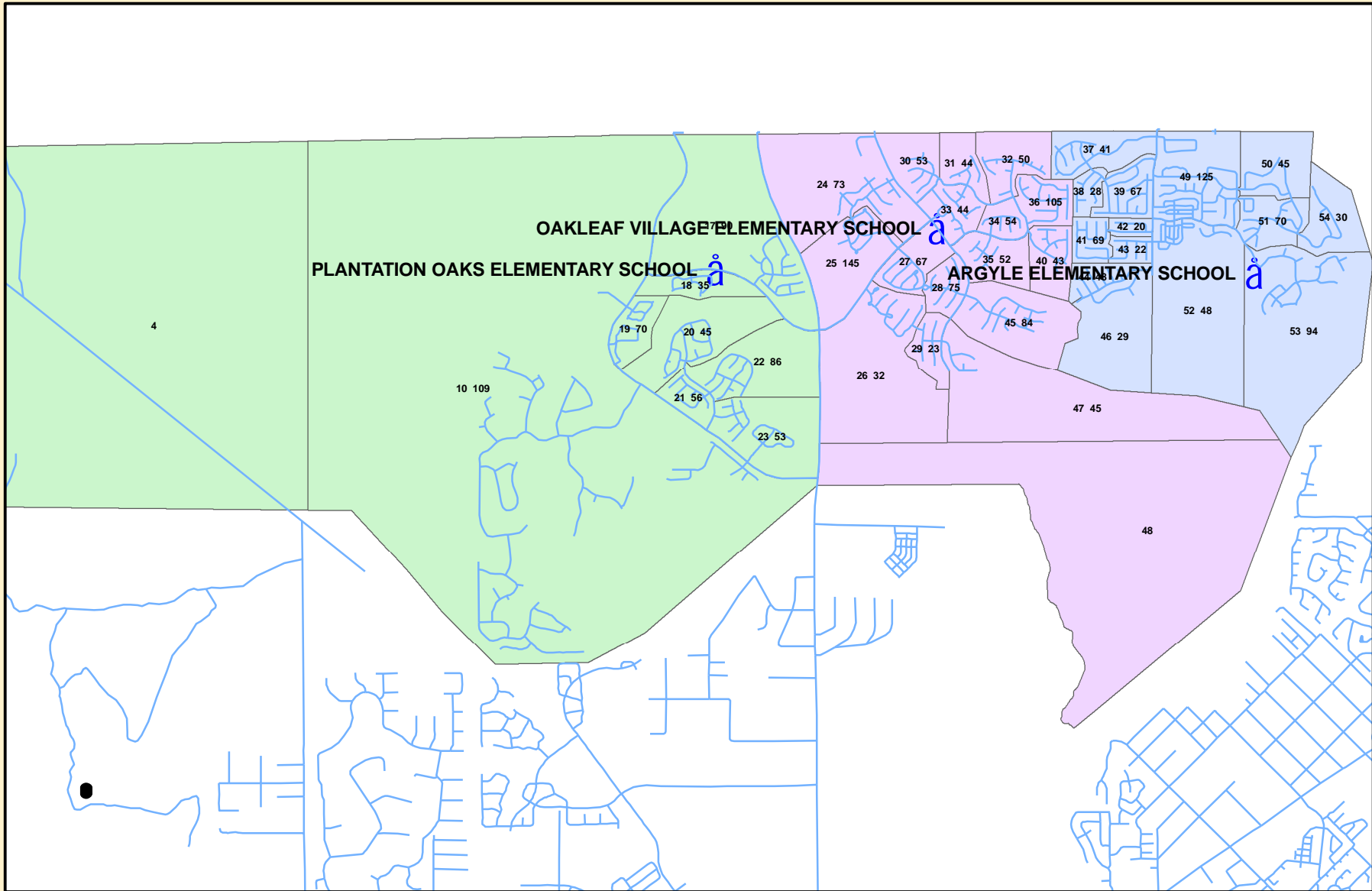

Legend

- AES
- OVE
- POE

**Proposed School Zones
for Oakleaf Area Elementary K-5
2009/2010**

*School District of Clay County
Facility Planning & Construction
October 22, 2008*



EXISTING

ARGYLE ELEMENTARY SCHOOL

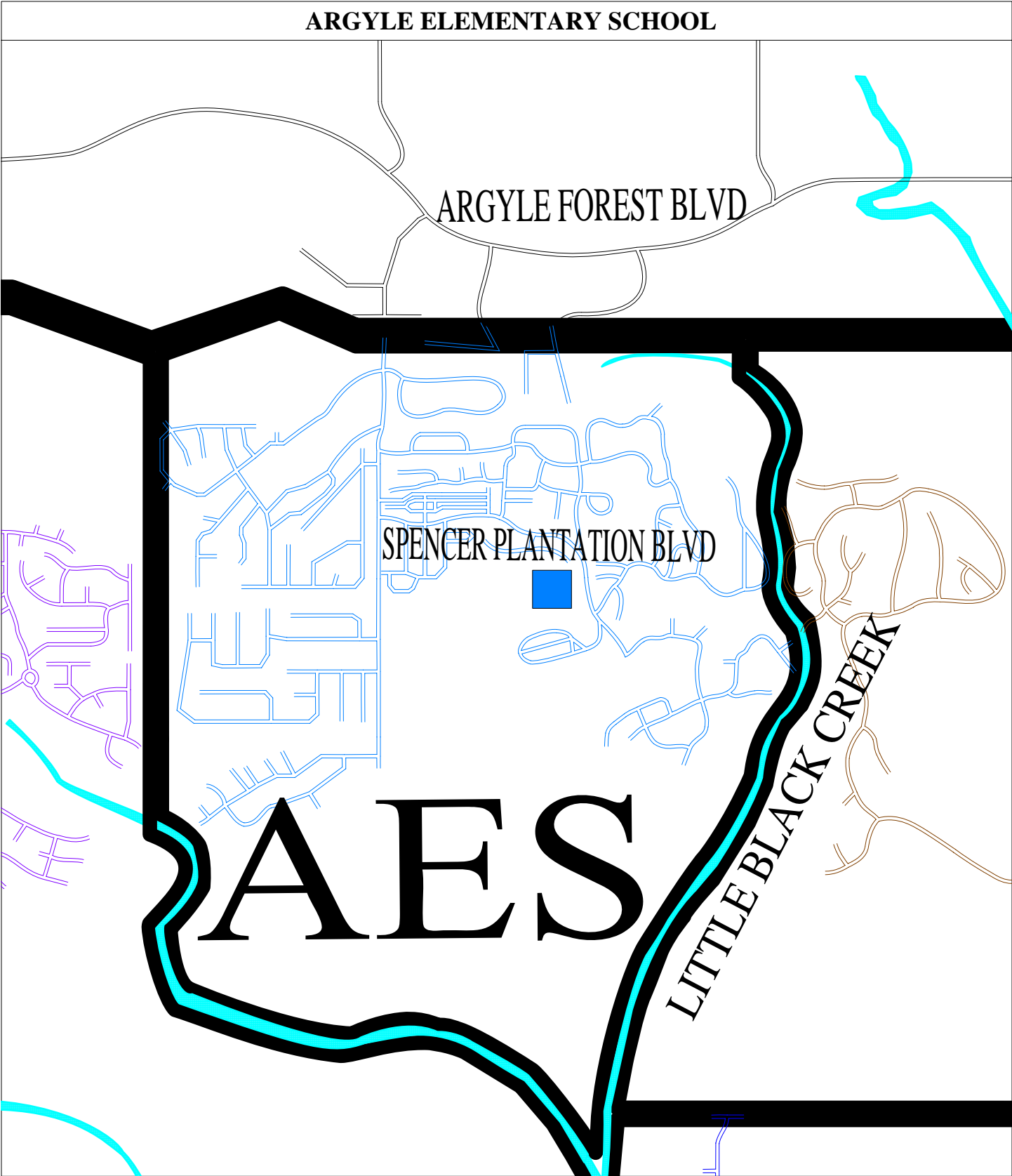

SCALE: 1852 ft/inch.

EXISTING

**OAKLEAF VILLAGE ELEMENTARY SCHOOL
(K-5)**

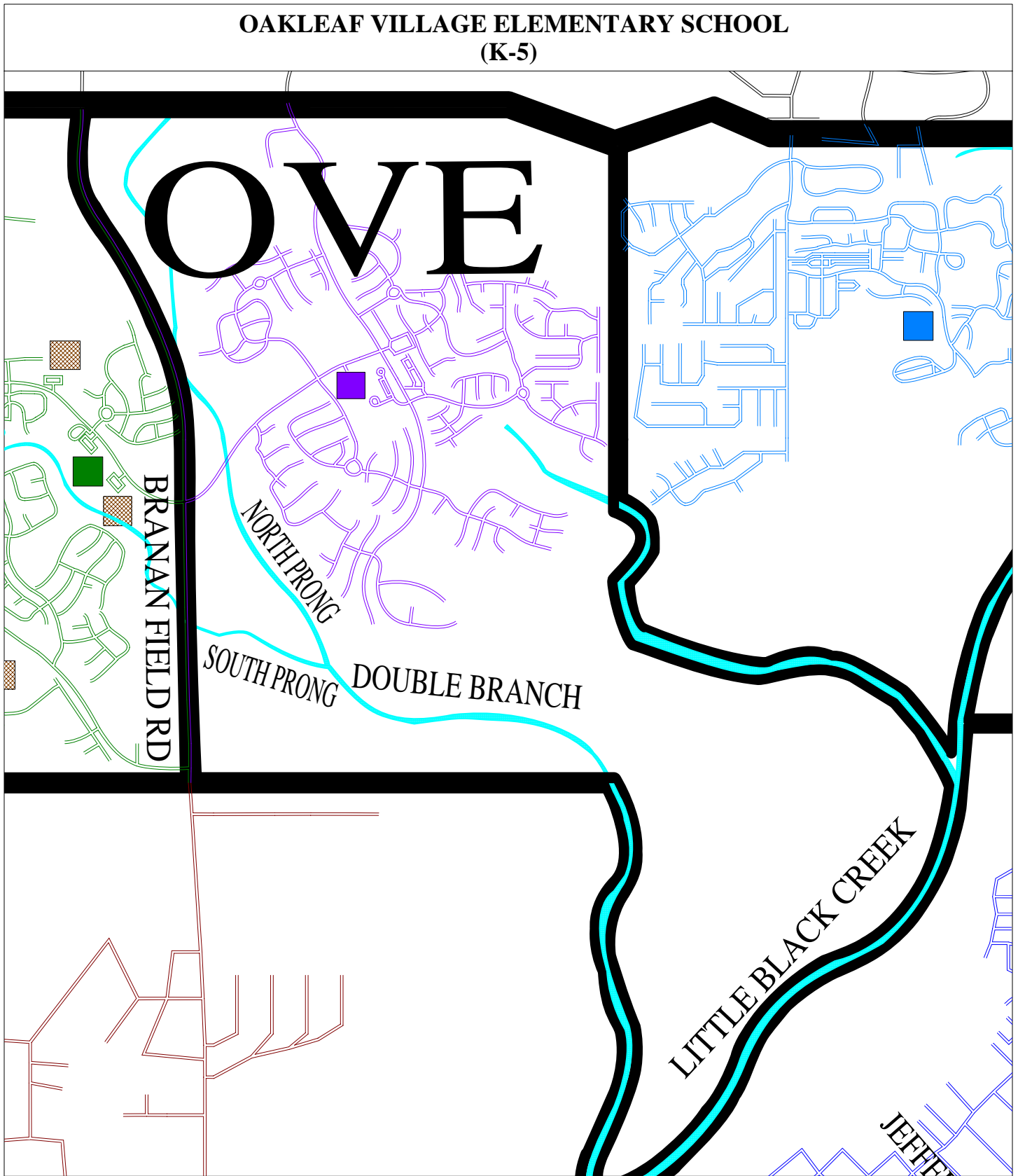

SCALE: 0.46 mi/inch.

EXISTING
**OAKLEAF SCHOOL
(K-5)**

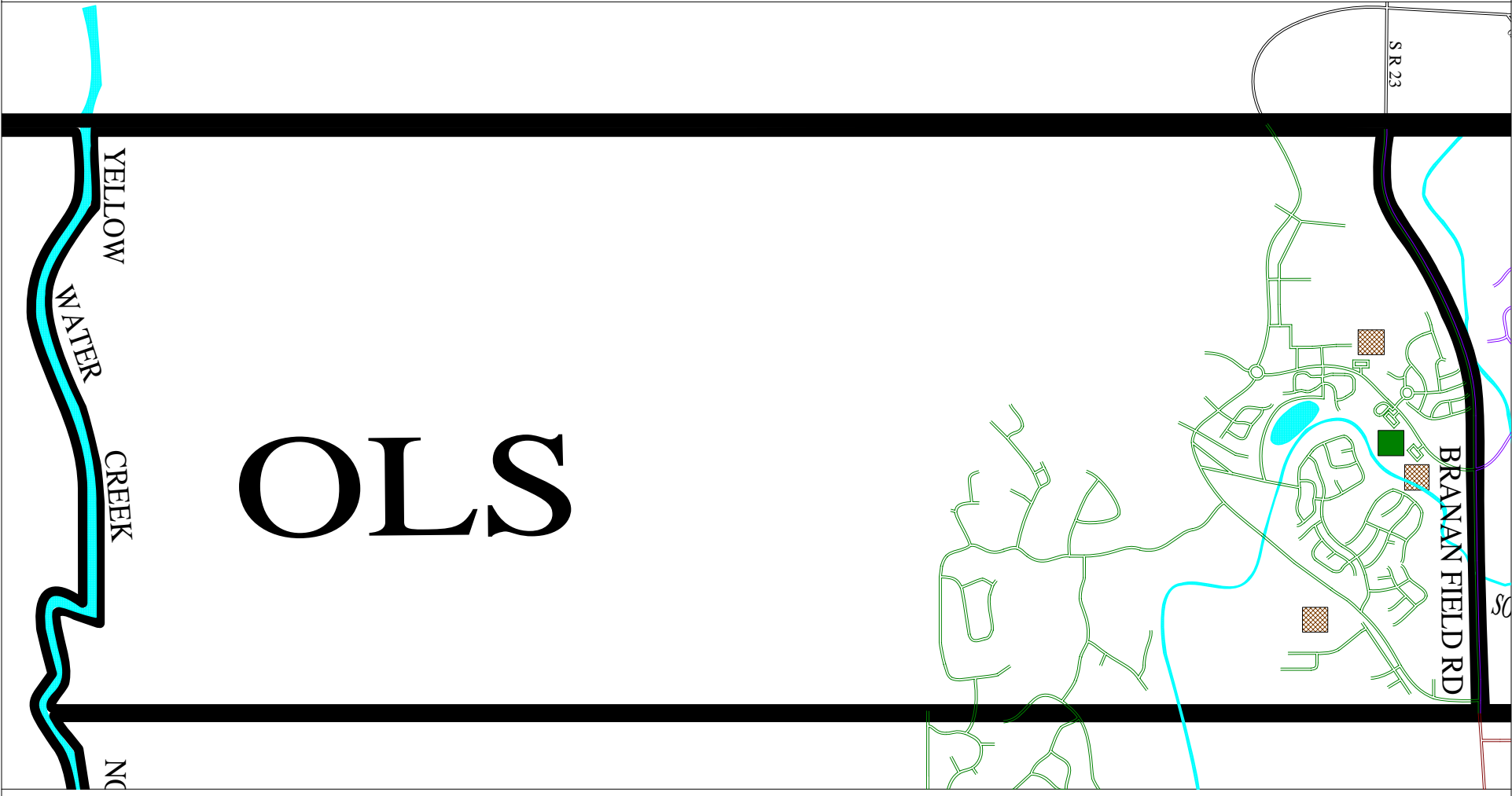

SCALE: 0.60 mi/inch.

EXISTING
OAKLEAF SCHOOL
(6)

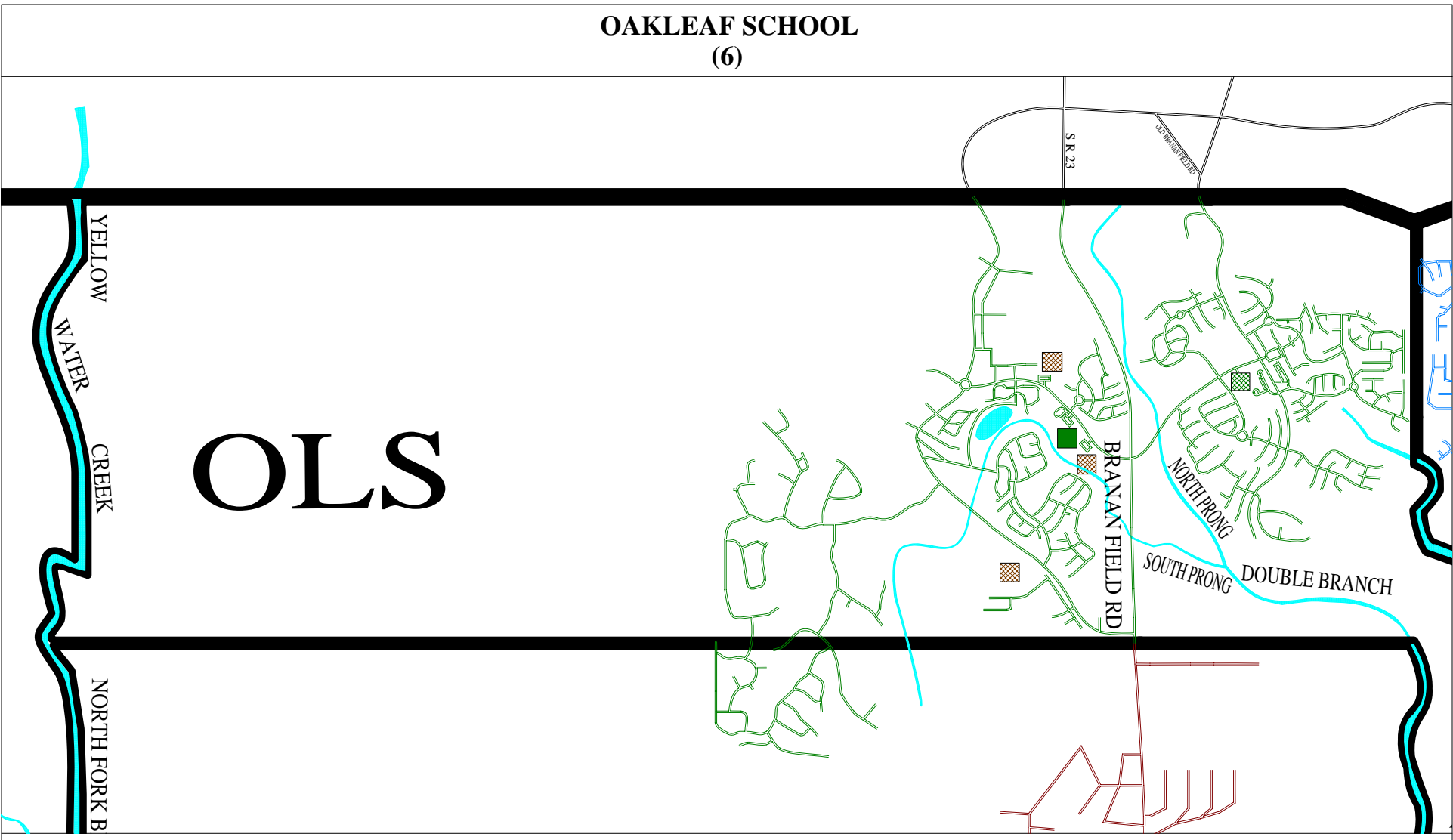

**OAKLEAF SCHOOL
(GRADES 7-8)**

DUVAL COUNTY

CLAY COUNTY

OLS

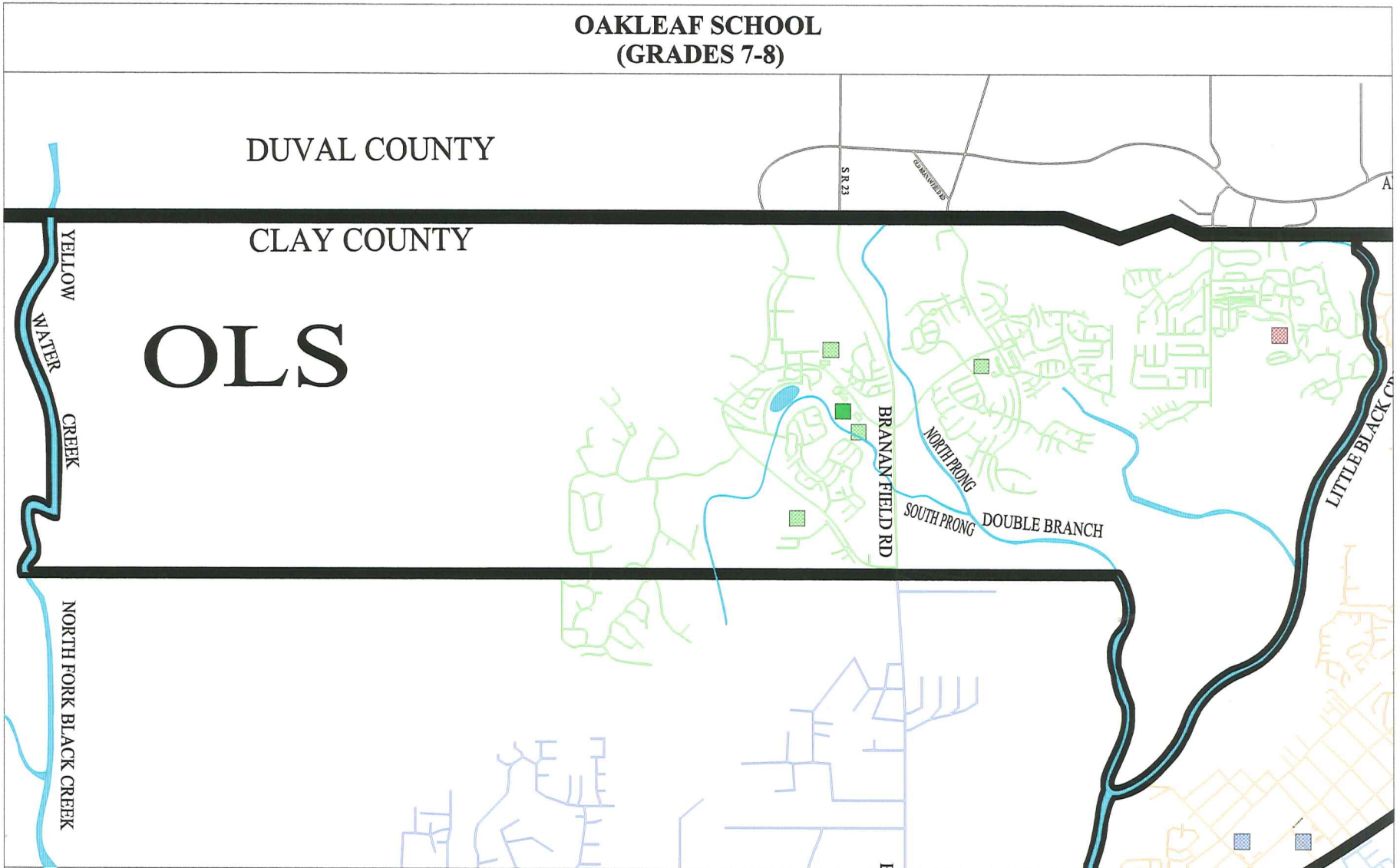

SCALE: 0.91 mi/inch.

Facility Planning & Construction

04-24-08

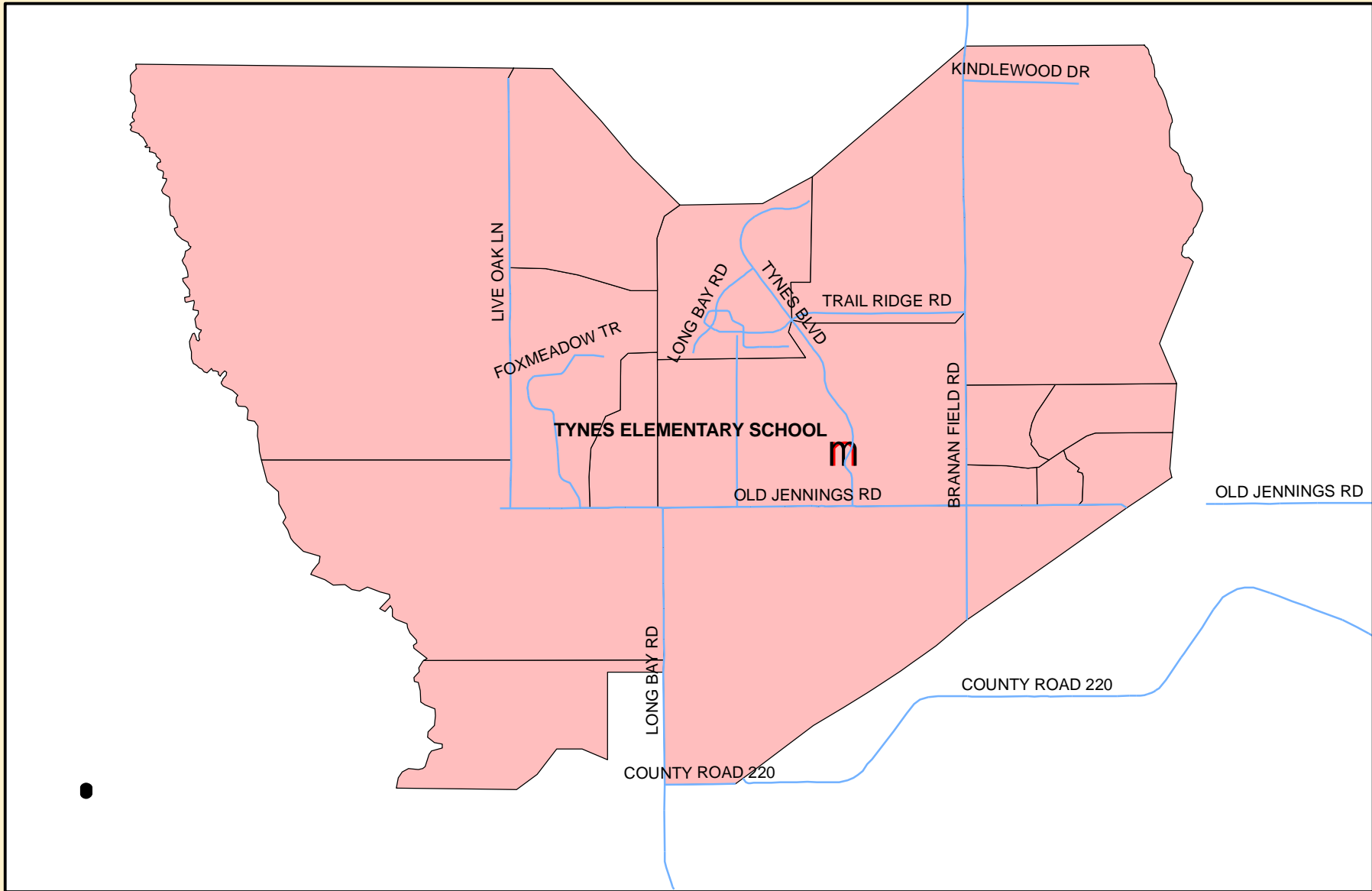

Legend

TES

**Proposed School Zone
for Tynes Elementary K-6
2009/2010**

*School District of Clay County
Facility Planning & Construction
November 12, 2008*



EXISTING

TYNES ELEMENTARY SCHOOL

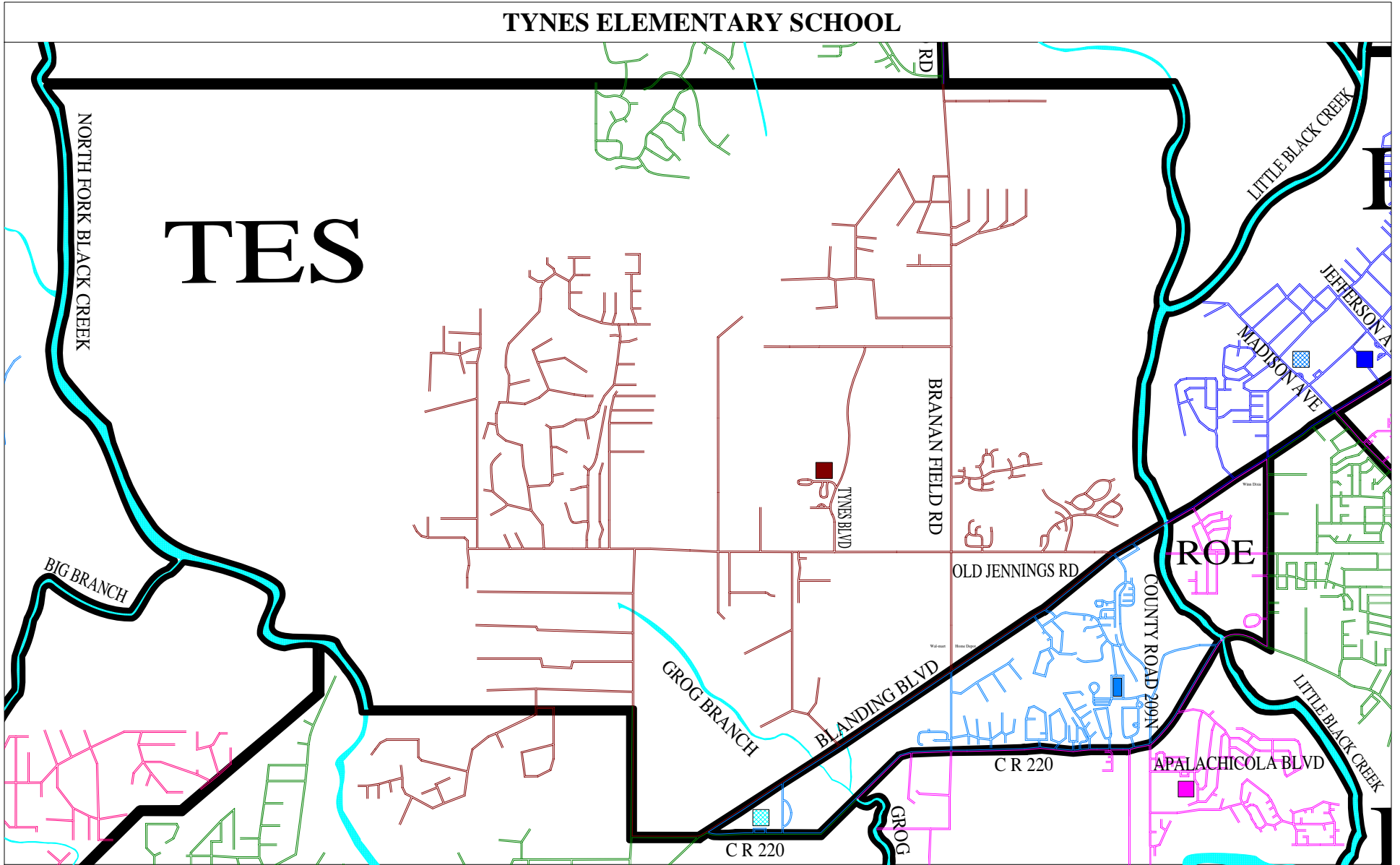

SCALE: 0.87 mi/inch.

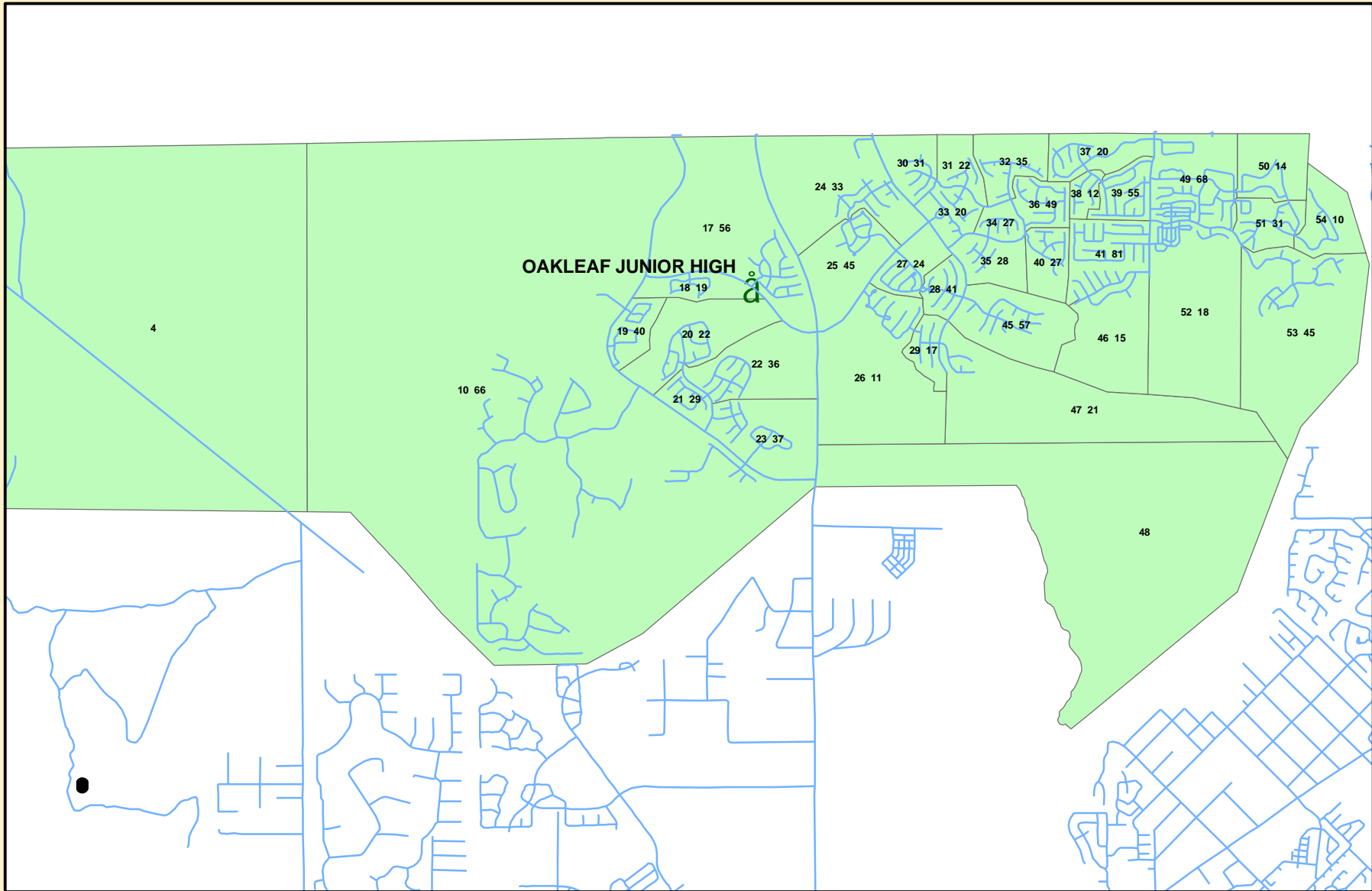

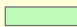
Legend
 OLS

Oakleaf Study Areas for Grades 6-8

*School District of Clay County
 Facility Planning & Construction
 October 22, 2008*



Effective
August, 2009

PLANTATION OAKS ELEMENTARY "Z"

(K-5 GRADE STRUCTURE)

ATTENDANCE ZONE AS FOLLOWS:

Beginning at the intersection of the center line of Yellow Water Creek and the northern Boundary of Clay County Section 32, Township 3 South, Range 24 East for a point of beginning; thence east to the center line of Branan Field Road; thence southeasterly along the center line of Branan Field Road to northeast corner of Section 18, Township 4 South, Range 25 East; thence on a diagonal to the southeastern corner of Section 13, Township 4 South, Range 24 East; thence due west along the section line to the southwestern corner of Section 13, Township 4 South, Range 24 East; thence northwesterly on a diagonal to the southeastern corner of Section 10, Township 4 South, Range 24 East; thence west along the section line to the center line of Yellow Water Creek; thence north along the center line of Yellow Water Creek to the point of beginning.

THIS ATTENDANCE ZONE WAS APPROVED BY THE CLAY COUNTY SCHOOL BOARD ON:

ORIGINAL APPROVAL -

**Effective
August, 2008 2009**

**ARGYLE ELEMENTARY SCHOOL
(K-6 5 GRADE STRUCTURE)**

ATTENDANCE ZONE AS FOLLOWS:

Begin at the intersection of the east section line of Section 34, Township 3 South, Range 25 East and the northern boundary of Clay County for a point of beginning; thence south along the section line to the center line of Little Black Creek; thence in a southerly direction along the center line of Little Black Creek to the intersection of Double Branch Creek; thence northwesterly along the center line of Double Branch Creek to the northern boundary of Section 9, Township 4 South, Range 25 East; thence due north to the northern boundary of Clay County; thence east along the northern boundary of Clay County to the point of beginning.

THIS ATTENDANCE ZONE WAS APPROVED BY THE CLAY COUNTY SCHOOL BOARD ON:

- ORIGINAL APPROVAL - April 17, 2003
- REVISION #1 - December 15, 2005
- REVISION #2 - January 17, 2008
- REVISION #3 - _____

Effective
August, 2008

OAKLEAF VILLAGE ELEMENTARY (W)

(K-5 GRADE STRUCTURE)

ATTENDANCE ZONE AS FOLLOWS:

Begin at the center line of Branan Field Road and northern boundary of Clay County tracking southeast along the ~~northern Clay County Boundary to the eastern boundary of Section 33, Township 3 South, Range 25 East;~~ thence southerly along the section line center line of Branan Field Road to the southwest corner of Section 8, Township 4 South, Range 25 East; thence due east along the section line to the center line of South Prong Double Branch Creek; thence east south along the center line of South Prong Double Branch Creek to the centerline of Little Black Creek; thence southerly northerly along the center line of Little Black Creek to the center line of ~~the North Prong Double Branch Creek;~~ thence northwesterly along the center line of ~~the North Prong Double Branch Creek~~ to the intersection ~~with the South Prong Double Branch Creek~~ of the northern boundary of Section 9, Township 4 South, Range 25 East; thence northwesterly due north to the center line of ~~Branan Field Road;~~ thence northerly along the center line of ~~Branan Field Road~~ to the northern boundary of Clay County; thence west along the Clay County border to the point of beginning.

THIS ATTENDANCE ZONE WAS APPROVED BY THE CLAY COUNTY SCHOOL BOARD ON:

ORIGINAL APPROVAL - January 17, 2008

TECHNICAL EDIT -

EFFECTIVE
August, ~~2007~~ 2009

TYNES ELEMENTARY SCHOOL
(K-6 GRADE STRUCTURE)

ATTENDANCE BOUNDARY AS FOLLOWS:

Begin at the intersection of the north section line of Section 17, Township 4 South, Range 24 East and Yellow Water Creek, for a point of beginning; thence southerly along the center line of Yellow Water Creek to the center line of the North Fork of Black Creek; thence along the center line of the North Fork of Black Creek in a southeasterly direction to a point on the north boundary of Section 3, Township 5 South, Range 24 East; thence east along the section line to the center line of Long Bay Road; thence south along the center line of Long Bay Road to the center line of County Road 220; thence east along the center line of County Road 220 to a point of intersection with the center line of State Road 21 (Blanding Boulevard); thence northeast along the center line of State Road 21 (Blanding Boulevard) to a point of intersection with Little Black Creek; thence northerly along the center line of Little Black Creek to the northern boundary of Section 16, Township 4 South, Range 25 East; thence west along the section line to the northwest corner of Section 17, Township 4 South, Range 25 East; thence southwest on a diagonal to the northeast corner of Section 24, Township 4 South, Range 24 East; thence due west along the section line to the southwest corner of Section 13, Township 4 South, Range 24 East; thence northwest on a diagonal to the northwest corner of Section 14, Township 4 South, Range 24 East; thence west along the section line to the point of beginning.

THIS ATTENDANCE ZONE WAS APPROVED BY THE CLAY COUNTY SCHOOL BOARD ON:

ORIGINAL APPROVAL - June 15, 1993

REVISION #1 - February 15, 2001

REVISION #2 - December 19, 2002

TECHNICAL EDIT - April 17, 2003

REVISION #3 - September 18, 2003

REVISION #4 - December 15, 2005

REVISION #5 - November 21, 2006

REVISION #6 -

Effective
August, 2006 2009

K-8 OAKLEAF JUNIOR HIGH SCHOOL "NN"

(6 7-8 GRADE STRUCTURE)

ATTENDANCE ZONE AS FOLLOWS:

Begin at the intersection of the center line of Yellow Water Creek and the northern boundary of Section 5, Township 4 South, Range 24 East a point along the northern Clay County Boundary for a point of beginning; thence due east along the northern border of Clay County to the ~~northeast~~ southeast corner of Section ~~3~~ 34, Township 4 ~~3~~ 3 South, Range 25 East; thence due south to the intersection of Little Black Creek; thence southerly along the center line of Little Black Creek to the intersection with the South Prong Double Branch Creek; thence northwesterly along the center line of the South Prong Double Branch Creek to the northern boundary of Section 16, Township 4 South, Range 25 East; thence westerly along the section line to the northwest corner of Section 17, Township 4 South, Range 25 East; thence southwest on a diagonal to the southwest corner of Section 18, Township 4 South, Range 24 East; thence due west along the section line to the southwest corner of Section 13, Township 4 South, Range 24 East; thence northwesterly on a diagonal to the southeastern corner of Section 10, Township 4 South, Range 24 east; thence due west along the section line to the intersection with the center line of Yellow Water Creek; thence north along the center line of Yellow Water Creek to the point of beginning.

THIS ATTENDANCE ZONE WAS APPROVED BY THE CLAY COUNTY SCHOOL BOARD ON:

ORIGINAL APPROVAL - December 15, 2005

REVISION #1 - _____

**RECOMMENDED ATTENDANCE BOUNDARY
ADVERTISEMENT**

ADVERTISEMENT IN: CLAY TODAY
FLORIDA TIMES UNION (MY CLAY SUN)

NEW ATTENDANCE BOUNDARY FOR

PLANTATION OAKS ELEMENTARY

WITH

**REVISIONS TO CONTIGUOUS ATTENDANCE BOUNDARIES OF
ARGYLE ELEMENTARY AND OAKLEAF VILLAGE ELEMENTARY**

**AND ADMINISTRATIVE REVISIONS TO
OAKLEAF JUNIOR HIGH AND TYNES ELEMENTARY**

The School Board of Clay County is considering establishing new attendance boundaries for Plantation Oaks Elementary scheduled to open August, 2009, and revisions to contiguous attendance boundaries of Argyle Elementary and OakLeaf Village Elementary and administrative revisions to OakLeaf Junior High and Tynes Elementary Schools to be effective at the start of school year 2009/10. A public hearing will be scheduled on this topic on January 15, 2009 at 7:00 p.m. in the Teacher In-Service Center at Fleming Island High School, 2233 Village Square Parkway, Orange Park, Florida.

For additional information, please contact Phil Hans, Facility Planning and Construction, 284-6516.